



13 Loch Lomond Crescent Burraneer NSW

4 4 2

Peacefully positioned on the prestigious Burraneer peninsula, this sprawling residence has been meticulously designed with striking and luxurious appeal. The home has been recently renovated to the highest of standards, the interiors have been carefully curated together with a focus on high end finishes, clever spatial arrangement that enhances quality living and comfort.

Nestled on a generous 874sqm in a quiet cul-de-sac, this home enjoys breathtaking views over the Port Hacking River. This remarkable entertainer enjoys multiple living areas, across a spacious floorplan suited to the largest of families. This home features an enviable bayside position close to waterways, Cronulla's beaches, schools, transport and shops.

Type : House

Price : Private Negotiation

View : <https://www.mattblakproperty.com.au/8103137>



Matthew Johnston
9529 3433

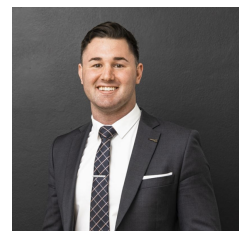

Billy Burke
9529 3433

[For full version visit the website](https://www.mattblakproperty.com.au)

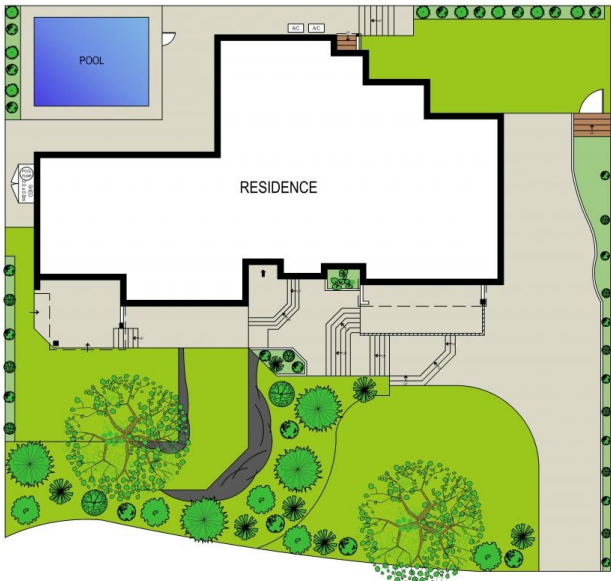

ADDRESS:
11-13 Loch Lomond Cres, Burraneer



DISCLAIMER: THIS IS FOR ILLUSTRATIVE PURPOSES ONLY, ALL DIMENSIONS ARE APPROXIMATE AND IT DOES NOT CONSTITUTE PART OF ANY LEGAL DOCUMENTS.