



28A Sylvan Street Sylvania NSW

4 2 2

Superbly built with unique quality fixtures and fittings throughout, this stunning home screams "easy living".

HIGHLIGHTS:

- Sun-filled open plan lounge & dining areas with high quality flooring
- Caesarstone kitchen benchtops with quality appliances PLUS walk in pantry
- Downstairs office/study
- Generous bedrooms upstairs with built-in robes
- Master bedroom features his & her closet and generous modern ensuite
- Lock up garage with internal access, ducted reverse cycle air conditioning
- * Pets upon application

Type : Semi Detached

View : <https://www.mattblakproperty.com.au/7775345>



Jasmine Quirk
9529 3433



Hannah Coughlan
95293343

[For full version visit the website](https://www.mattblakproperty.com.au)

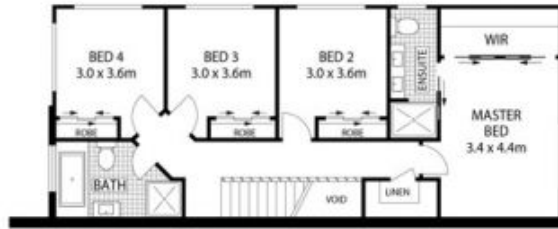

FIRST FLOOR



GROUND FLOOR



SITE PLAN



APPROX. INT :169m²

THE INFORMATION CONTAINED IN THIS DOCUMENT HAS BEEN PROVIDED BY THIRD PARTIES. THE AGENCY HAS NOT CHECKED THE INFORMATION AND HEREBY PASSES IT ON, NOT HAVING A BELIEF ONE WAY OR THE OTHER AS TO ITS ACCURACY. INTERESTED PARTIES SHOULD MAKE AND RELY UPON THEIR OWN ENQUIRIES.